

RECORD OF SURVEY

A PORTION OF SECTION 1, TOWNSHIP 20 N., RANGE 17 E., W.M., KITTITAS COUNTY, WASHINGTON

EXISTING LEGAL DESCRIPTION PER CHICAGO TITLE INSURANCE COMPANY - POLICY NO. 72156-47739083:

(PARCEL 413733)

THAT PORTION OF SECTION 1, TOWNSHIP 20 NORTH, RANGE 17 EAST, W.M., IN THE COUNTY OF KITTITAS, STATE OF WASHINGTON, WHICH IS A PORTION OF "JUMBO" PLACER CLAIM AND WHICH IS BOUNDED BY A LINE DESCRIBED AS FOLLOWS:

BEGINNING AT CORNER NO. 1 OF "JUMBO" PLACER CLAIM, FROM WHENCE THE STANDARD SOUTH QUARTER OF SECTION 36, TOWNSHIP 21 NORTH, RANGE 17 EAST BEARS NORTH 16°44'41" WEST, 1438.45 FEET DISTANT; THENCE SOUTH 846.51 FEET TO CORNER NO. 2; THENCE WEST 920 FEET TO CORNER NO. 3; THENCE NORTH 846.51 FEET TO CORNER NO. 4; THENCE SOUTH ALONG WEST LINE OF SAID "JUMBO" PLACER CLAIM 243.51 FEET TO POINT OF BEGINNING; THENCE SOUTH 400 FEET; THENCE EAST 218 FEET; THENCE NORTH 400 FEET; THENCE WEST 218 FEET TO POINT OF BEGINNING.

(PARCEL 443733 & 962356)

PORTIONS OF JUMBO AND FOURTH OF JULY MINING CLAIMS:

A PORTION OF THE NORTHWEST QUARTER OF SECTION 1, TOWNSHIP 20 NORTH, RANGE 17 EAST, W.M., KITTITAS COUNTY, STATE OF WASHINGTON, DESCRIBED AS FOLLOWS:

BEGINNING AT THE SOUTH QUARTER CORNER OF SECTION 36; THENCE SOUTH 16°44'41" WEST, 1,434.09 FEET; THENCE SOUTH 00°23'20" EAST, 319.89 FEET TO THE TRUE POINT OF BEGINNING; THENCE NORTH 53°49'00" WEST, 897.62 FEET TO THE SOUTHEAST RIGHT-OF-WAY OF FOREST SERVICE RIGHT OF WAY DATED APRIL 9, 1968, FOR WILLIAMS CREEK ROAD #2102; THENCE SOUTH 36°11'00" WEST ALONG THE RIGHT OF WAY OF FOREST SERVICE ROAD, 10 FEET; THENCE ON A CURVE TO THE RIGHT ALONG THE RIGHT OF WAY A RADIUS OF 330 FEET AN ARC DISTANCE OF 94.59 FEET; THENCE SOUTH 00°34'10" EAST, 140.34 FEET; THENCE SOUTH 89°35'11" WEST, 127.90 FEET; THENCE SOUTH 00°44'08" EAST, 247.07 FEET; THENCE NORTH 89°18'38" EAST, 218.06 FEET; THENCE SOUTH 00°34'34" EAST, 401.34 FEET; THENCE SOUTH 89°38'48" WEST, 217.34 FEET; THENCE SOUTH 00°14'22" EAST, 199.83 FEET; THENCE NORTH 89°30'36" EAST, 917.70 FEET; THENCE NORTH 00°23'20" WEST, 525.84 FEET TO THE TRUE POINT OF BEGINNING.

EXCEPTING THAT PORTION LYING NORTHERLY OF WILLIAMS CREEK.

PRELIMINARY LEGAL DESCRIPTION AS A RESULT OF PARCEL ADJUSTMENT:

JONES PARCEL NO. 413733:

THAT PORTION OF SECTION 1, TOWNSHIP 20 NORTH, RANGE 17 EAST, W.M., IN THE COUNTY OF KITTITAS, STATE OF WASHINGTON, WHICH IS A PORTION OF "JUMBO" PLACER CLAIM AND WHICH IS BOUNDED BY A LINE DESCRIBED AS FOLLOWS:

BEGINNING AT CORNER NO. 1 OF "JUMBO" PLACER CLAIM, FROM WHENCE THE STANDARD SOUTH QUARTER OF SECTION 36, TOWNSHIP 21 NORTH, RANGE 17 EAST BEARS NORTH 16°44'41" WEST, 1438.45 FEET DISTANT; THENCE SOUTH 846.51 FEET TO CORNER NO. 2; THENCE WEST 920 FEET TO CORNER NO. 3; THENCE NORTH 846.51 FEET TO CORNER NO. 4; THENCE SOUTH ALONG WEST LINE OF SAID "JUMBO" PLACER CLAIM 243.51 FEET TO POINT OF BEGINNING; THENCE SOUTH 400 FEET; THENCE EAST 218 FEET; THENCE NORTH 400 FEET; THENCE WEST 218 FEET TO POINT OF BEGINNING.

EXCEPT:

THAT PORTION OF THE HEREINABOVE DESCRIBED PARCEL BEING MORE PARTICULARLY DESCRIBED AS FOLLOWS:

COMMENCING AT THE SOUTHWEST CORNER OF THE HEREINABOVE DESCRIBED JONES PARCEL, SAID CORNER BEING THE TRUE POINT OF BEGINNING;
THENCE NORTH 89°35'17" EAST, 217.36 FEET;

THENCE SOUTH 00°37'57" EAST, 9.16 FEET;

THENCE SOUTH 89°35'17" WEST, 217.33 FEET;

THENCE NORTH 00°47'51" WEST, 9.16 FEET TO THE TRUE POINT OF BEGINNING.

TOGETHER WITH:

A PORTION OF THAT CERTAIN PARCEL OF LAND DESCRIBED IN THAT CERTAIN STATUTORY WARRANTY DEED FROM ALLEN W. SLOAN AND BARBARA R. SLOAN TO LARRY A. SMITH AND ANNA L. SMITH, RECORDED ON MAY 17, 1994, UNDER AUDITOR'S FILE NO. 570879, RECORDS OF SAID COUNTY;

SAID PARCEL BEING A PORTION OF THE "JUMBO" AND "FORTH OF JULY" MINING CLAIMS AND BEING A PORTION OF SAID SECTION 1 AND BEING MORE PARTICULARLY DESCRIBED AS FOLLOWS:

COMMENCING AT THE SOUTHWEST CORNER OF THE HEREINABOVE DESCRIBED PARCEL THENCE NORTH 00°14'22" WEST, ALONG THE WEST BOUNDARY OF SAID PARCEL, 199.83 FEET;

THENCE NORTH 89°35'17" EAST, 217.34 FEET;

THENCE NORTH 00°37'57" EAST, 211.59 FEET TO THE TRUE POINT OF BEGINNING;

THENCE NORTH 89°25'26" EAST, 12.52 FEET;

THENCE SOUTH 16°28'57" EAST, 67.77 FEET;

THENCE SOUTH 00°34'34" EAST, 18.41 FEET;

THENCE SOUTH 89°25'26" WEST, 31.01 FEET;

THENCE NORTH 00°37'57" WEST, 83.58 FEET TO THE TRUE POINT OF BEGINNING.

PRELIMINARY LEGAL DESCRIPTION AS A RESULT OF PARCEL ADJUSTMENT:

SMITH PARCEL NO. 443733 AND 962356:

THAT PORTION OF SECTION 1, TOWNSHIP 20 NORTH, RANGE 17 EAST, W.M., IN THE COUNTY OF KITTITAS, STATE OF WASHINGTON, WHICH IS A PORTION OF "JUMBO" PLACER CLAIM AND WHICH IS BOUNDED BY A LINE DESCRIBED AS FOLLOWS:

BEGINNING AT CORNER NO. 1 OF "JUMBO" PLACER CLAIM, FROM WHENCE THE STANDARD SOUTH QUARTER OF SECTION 36, TOWNSHIP 21 NORTH, RANGE 17 EAST BEARS NORTH 16°44'41" WEST, 1438.45 FEET DISTANT; THENCE SOUTH 846.51 FEET TO CORNER NO. 2; THENCE WEST 920 FEET TO CORNER NO. 3; THENCE NORTH 846.51 FEET TO CORNER NO. 4; THENCE SOUTH ALONG WEST LINE OF SAID "JUMBO" PLACER CLAIM 243.51 FEET TO POINT OF BEGINNING; THENCE SOUTH 400 FEET; THENCE EAST 218 FEET; THENCE NORTH 400 FEET; THENCE WEST 218 FEET TO POINT OF BEGINNING.

EXCEPT:

THAT PORTION OF THE HEREINABOVE DESCRIBED PARCEL BEING MORE PARTICULARLY DESCRIBED AS FOLLOWS:

COMMENCING AT THE SOUTHWEST CORNER OF THE HEREINABOVE DESCRIBED JONES PARCEL, SAID CORNER BEING THE TRUE POINT OF BEGINNING;
THENCE NORTH 89°35'17" EAST, 217.36 FEET;

THENCE SOUTH 00°37'57" EAST, 9.16 FEET;

THENCE SOUTH 89°35'17" WEST, 217.33 FEET;

THENCE NORTH 00°47'51" WEST, 9.16 FEET TO THE TRUE POINT OF BEGINNING.

TOGETHER WITH:

A PORTION OF THAT CERTAIN PARCEL OF LAND DESCRIBED IN THAT CERTAIN STATUTORY WARRANTY DEED FROM ALLEN W. SLOAN AND BARBARA R. SLOAN TO LARRY A. SMITH AND ANNA L. SMITH, RECORDED ON MAY 17, 1994, UNDER AUDITOR'S FILE NO. 570879, RECORDS OF SAID COUNTY;

SAID PARCEL BEING A PORTION OF THE "JUMBO" AND "FORTH OF JULY" MINING CLAIMS AND BEING A PORTION OF SAID SECTION 1 AND BEING MORE PARTICULARLY DESCRIBED AS FOLLOWS:

COMMENCING AT THE SOUTHWEST CORNER OF THE HEREINABOVE DESCRIBED PARCEL THENCE NORTH 00°14'22" WEST, ALONG THE WEST BOUNDARY OF SAID PARCEL, 199.83 FEET;

THENCE NORTH 89°35'17" EAST, 217.34 FEET;

THENCE NORTH 00°37'57" EAST, 211.59 FEET TO THE TRUE POINT OF BEGINNING;

THENCE NORTH 89°25'26" EAST, 12.52 FEET;

THENCE SOUTH 16°28'57" EAST, 67.77 FEET;

THENCE SOUTH 00°34'34" EAST, 18.41 FEET;

THENCE SOUTH 89°25'26" WEST, 31.01 FEET;

THENCE NORTH 00°37'57" WEST, 83.58 FEET TO THE TRUE POINT OF BEGINNING.

LINE TABLE		
LINE #	DIRECTION	DISTANCE
L1	N 88°59'29" E	18.24'
L2	N 7°23'42" E	51.39'
L3	N 18°13'14" E	57.23'
L4	N 85°47'54" E	23.90'
L5	S 83°31'56" E	66.56'
L6	N 42°32'36" E	41.06'
L7	N 14°18'17" E	20.49'
L8	N 72°04'17" E	46.80'
L9	N 73°47'47" E	43.81'
L10	S 46°29'57" E	44.81'
L11	N 53°21'18" E	46.49'
L12	N 25°46'57" E	50.78'
L13	N 54°22'32" W	32.58'
L14	N 69°02'51" E	56.96'
L15	N 49°05'08" E	24.28'
L16	S 61°45'24" E	32.04'
L17	N 75°32'24" E	28.56'
L18	S 45°00'49" E	23.78'
L19	N 45°00'05" E	16.09'
L20	S 0°37'57" E	191.61'

LINE TABLE		
LINE #	DIRECTION	DISTANCE
L21	S 0°37'57" E	83.58'
L22	S 89°25'26" W	12.52'
L23	S 16°28'57" E	67.77'
L24	N 0°34'34" W	18.41'
L25	S 89°25'26" W	31.01'
L26	S 0°37'57" E	118.14'
L27	S 0°37'57" E	9.16'
L28	N 0°47'51" W	9.16'

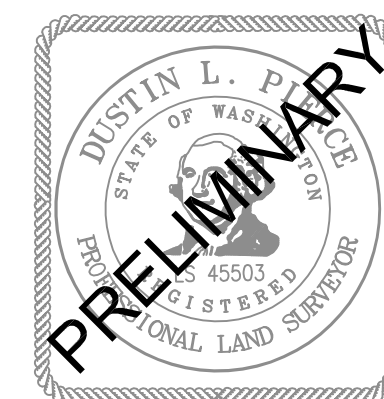

<p>AUDITOR'S CERTIFICATE _____</p> <p>FILED FOR RECORD THIS ____ DAY OF ____ 20__ AT ____ M.</p> <p>IN BOOK ____ OF _____ AT PAGE ____ AT THE REQUEST OF</p> <p style="text-align: center;">_____ DUSTIN L. PIERCE SURVEYOR'S NAME</p> <p style="text-align: center;">_____ JERALD V. PETTIT County Auditor Deputy County Auditor</p>	<p>Western Washington Division 165 NE Juniper Street, Suite 201 • Issaquah, WA 98027 • Phone: (425) 392-0250</p> <p>Eastern Washington Division 407 Swiftwater Blvd. • Cle Elum, WA 98922 • Phone: (509) 674-7433</p>	<p style="text-align: center;">BOUNDARY LINE ADJUSTMENT BL-22-00021</p> <p style="text-align: center;">PREPARED FOR MARK JONES A PORTION OF SECTION 1, TOWNSHIP 20 NORTH, RANGE 17 EAST, W.M. KITTITAS COUNTY WASHINGTON</p> <table border="1" style="width: 100%; border-collapse: collapse;"> <tr> <td style="width: 33%;">DWN BY GW/JR/DLP</td> <td style="width: 33%;">DATE 11/2022</td> <td style="width: 33%;">JOB NO. 21098</td> </tr> <tr> <td>CHKD BY D.L.P.</td> <td>SCALE N/A</td> <td>SHEET 2 OF 2</td> </tr> </table>	DWN BY GW/JR/DLP	DATE 11/2022	JOB NO. 21098	CHKD BY D.L.P.	SCALE N/A	SHEET 2 OF 2
DWN BY GW/JR/DLP	DATE 11/2022	JOB NO. 21098						
CHKD BY D.L.P.	SCALE N/A	SHEET 2 OF 2						